

99266

Dimensions

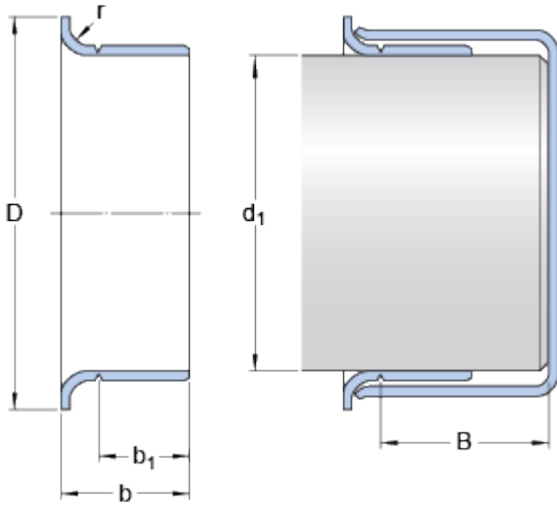

Nominal dimensions

d_1		68	mm
D		79.375	mm
Tolerance outside diameter D	\pm	1.6	mm
b		22.225	mm
Tolerance width b	\pm	0.8	mm
b_1		19.05	mm
Tolerance width b_1	\pm	0.8	mm
B	max.	42.875	mm
r	max.	3.18	mm

Shaft diameter range

d_1	min.	67.818	mm
d_1	max.	67.996	mm